



HCFS 200 SERIES

Normal-Duty 4-Bolt Flange Block
Eccentric Lock

TURNER
Mounted Bearings

Available Seal Styles:

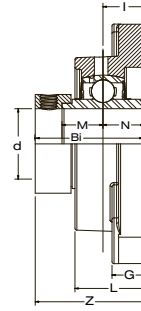
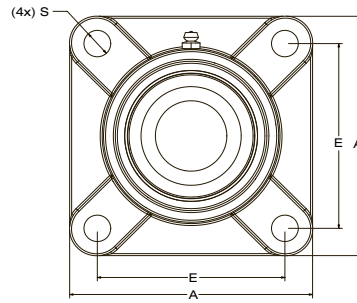
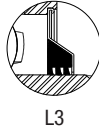

Bearing Number	Shaft Dia. d in. mm.	Dimensions in. mm.										Bolt Used in. mm.	Load Rating lbs. kN.		Bearing Insert	Housing Number	Weight lbs. kg.		
		A	E	I	G	L	S	Z	Bi	N	M		Dynamic C _r	Static C _{0r}					
HCWF 201	12																		
HCWF 201-8	1/2																		
HCWF 202	15	3.00	2.125	0.59	0.44	1.00	0.44	1.50	1.4685	0.5472	0.5472	3/8	2,147	1,075	HCW 201	WF 203	1.3		
HCWF 202-10	5/8	76.0	54.0	15.0	11.0	25.5	11.0	38.4	37.3	13.9	13.9	M10	9.55	4.78	HCW 202		0.6		
HCWF 203	17														HCW 202-10				
HCWF 203	17														HCW 203				
HCFS 204-12	3/4	3.38	2.500	0.75	0.59	1.16	0.45	1.81	1.7205	0.6732	0.6732	3/8	2,883	1,496	HC 204-12	FS 204	2.0		
HCFS 204	20	86	63.5	19.0	15.0	29.5	11.5	45.6	43.7	17.1	17.1	M10	12.82	6.65	HC 204		0.9		
HCFS 205-14	7/8																		
HCFS 205-15	15/16	3.66	2.750	0.75	0.59	1.19	0.45	1.81	1.7480	0.6850	0.6850	7/16	3,155	1,810	HC 205-14	FS 205	2.2		
HCFS 205	25	93.0	69.9	19.0	15.0	30.0	11.5	46.0	44.4	17.4	17.4	M10	14.04	8.05	HC 205-15		1.0		
HCFS 205	25														HC 205				
HCFS 205-16	1														HC 205-16				
HCFS 206-17	1 1/16																		
HCFS 206-18	1 1/8																		
HCFS 206	30	4.19	3.250	0.80	0.63	1.28	0.51	1.97	1.9055	0.7165	0.7165	1/2	4,377	2,569	HC 206-17	FS 206	2.6		
HCFS 206-19	1 3/16	106.0	82.6	20.0	16.0	32.5	13.0	50.2	48.4	18.2	18.2	M12	19.47	11.43	HC 206-18		1.2		
HCFS 206	30														HC 206				
HCFS 206-19	1 3/16														HC 206-19				
HCFS 206-20	1 1/4														HC 206-20				
HCFS 207-20	1 1/4																		
HCFS 207-21	1 5/16																		
HCFS 207-22	1 3/8	4.56	3.625	0.83	0.69	1.38	0.51	2.09	2.0118	0.7402	0.7402	1/2	5,775	3,497	HC 207-20	FS 207	3.5		
HCFS 207	35	116.0	92.1	21.0	17.0	35.0	13.0	53.3	51.1	18.8	18.8	M12	25.69	15.56	HC 207-21		1.6		
HCFS 207	35														HC 207-22				
HCFS 207-23	1 7/16														HC 207				
HCFS 208-24	1 1/2																		
HCFS 208-25	1 9/16	5.06	4.000	0.94	0.69	1.54	0.55	2.31	2.2165	0.8425	0.8425	1/2	6,634	4,079	HC 208-24	FS 208	3.7		
HCFS 208	40	129	101.6	24.0	17.0	39.0	14.0	58.9	56.3	21.4	21.4	M12	29.51	18.14	HC 208-25		1.7		
HCFS 208	40														HC 208				
HCFS 209-26	1 5/8																		
HCFS 209-27	1 11/16	5.31	4.125	0.94	0.71	1.57	0.63	2.31	2.2165	0.8425	0.8425	1/2	7,160	4,676	HC 209-26	FS 209	5.3		
HCFS 209-28	1 3/4	135.0	104.8	24.0	18.0	40.0	16.0	58.9	56.3	21.4	21.4	M12	31.85	20.80	HC 209-27		2.4		
HCFS 209	45														HC 209-28				
HCFS 209	45														HC 209				
HCFS 210-30	1 7/8																		
HCFS 210-31	1 15/16	5.63	4.375	1.09	0.80	1.78	0.69	2.60	2.4685	0.9685	0.9685	9/16	7,867	5,330	HC 210-30	FS 210	6.4		
HCFS 210	50	143.0	111.1	28.0	20.0	45.0	17.0	66.1	62.7	24.6	24.6	M16	35.00	23.71	HC 210-31		2.9		
HCFS 210	50														HC 210				
HCFS 210-32	2																		
HCFS 211-32	2																		
HCFS 211-34	2 1/8	6.38	5.125	1.22	0.81	1.94	0.69	2.94	2.8110	1.0906	1.0906	5/8	9,743	6,608	HC 210-32	FS 211	9.9		
HCFS 211	55	162.0	130.2	31.0	21.0	49.0	17.0	74.7	71.4	27.7	27.7	M16	43.34	29.40	HC 211-32		4.5		
HCFS 211	55														HC 211-34				
HCFS 211-35	2 3/16														HC 211				
HCFS 212-36	2 1/4																		
HCFS 212	60	6.89	5.625	1.34	0.88	2.13	0.69	3.19	3.0630	1.2165	1.2165	5/8	10,720	7,516	HC 212-36	FS 212	12.3		
HCFS 212-38	2 3/8	175.0	142.9	34.0	22.0	53.5	17.0	80.9	77.8	30.9	30.9	M16	47.69	33.43	HC 212		5.6		
HCFS 212-38	2 3/8														HC 212-38				
HCFS 212-39	2 7/16														HC 212-39				
HCFS 213-40	2 1/2	7.25	5.875	1.50	0.88	2.28	0.71	3.50	3.3740	1.3425	1.3425	5/8	12,859	8,994	HC 213-40	FS 213	13.6		
HCFS 213	65	184.0	149.2	38.0	22.0	58.0	18.0	89.6	85.7	34.1	34.1	M16	57.20	40.01	HC 213		6.2		
HCFS 214-43	2 11/16																		
HCFS 214-44	2 3/4	7.38	5.875	1.50	0.91	2.38	0.71	3.50	3.3740	1.3425	1.3425	5/8	13,981	9,869	HC 214-43	FS 214	13.6		
HCFS 214	70	188.0	149.2	38.0	23.0	60.0	18.0	89.6	85.7	34.1	34.1	M16	62.19	43.90	HC 214-44		6.2		
HCFS 214	70														HC 214				
HCFS 215-47	2 15/16																		
HCFS 215	75	7.88	6.000	1.61	0.94	2.44	0.79	3.78	3.6260	1.4685	1.4685	7/8	14,974	10,757	HC 215-47	FS 215	16.3		
HCFS 215-48	3	200.0	152.4	41.0	24.0	62.0	20.0	95.8	92.1	37.3	37.3	M18	66.61	47.85	HC 215		7.9		